

BIOMETRIC TERMINAL FOR T&A AND SIMPLE ACCESS CONTROL



BIO TIME PLUS

- ▶ High-Density PVC Housing.
- ▶ Color Screen.
- ▶ Fingerprint, Password, Proximity Card.
- ▶ USB-Host, Network (TCP/IP)
- ▶ New Connectivity: Wi-Fi
- ▶ Simple Access Control
- ▶ 3,000 Fingerprints, 3,000 Proximity Cards, and 50,000 Records

Built-in Battery

BioTime Plus is a biometric terminal with a 2.8-inch color screen, designed for managing Time and Attendance and basic Access Control applications. It includes the **Z-ID fingerprint reader** for effective recognition and verification, as well as internal Wi-Fi for convenient communication.

BioTime Plus can be managed through its **TCP/IP network interface**, Wi-Fi, or via its USB port for manual data transfer to avoid the risk of accidental data deletion. It can be easily managed via **RS232/485, TCP/IP, and USB-Client**, and it also has a backup and data recovery function to prevent loss of information in case of accidental deletion.

Wi-Fi: The integrated Wi-Fi module operates on the 2.4G radio band and complies with IEEE 802.11b/g/n standards.

Z-ID: Employing the Z-ID fingerprint reader to achieve excellent recognition. It works well with dry, wet, and rough fingerprints.

ADMS: Optional for devices used globally. Resolving the device's limited capacity through the HTTP network. Devices can connect, charge, and copy data automatically. This is useful for management and monitoring devices.

USB: Supports USB-Host connection for backing up and managing information when the device is standalone.

BUILT-IN BATTERY: Offers an additional 4 hours of operation in case of power failure.



BIOMETRIC TERMINAL FOR T&A AND SIMPLE ACCESS CONTROL



BIO TIME PLUS

SPECIFICATIONS

- Part Number: BIOTIME PLUS
- Fingerprint Capacity: 3.000
- Card Capacity: 3.000 (optional)
- Card Reading: RFID de 125 Kz.
- Event Capacity: 50.000
- Screen: 2.8-inch color screen.
- Communication: TCP/IP, Wi-Fi, USB-Client.
- Standard Functions: SMS, daylight saving time, web server, scheduled bell, work code, automatic status change, self-service search, T9 input, 9-digit ID.
- Optional Functions: ID/IC Card, ADMS, External Printer RS232.
- Power Supply: DC 12V/1.5A
- Operating Temperature: 0 °C - 45 °C
- Verification Humidity: 20% - 80%
- Dimensions: 185 x 137 x 38.2 mm

CONFIGURATION

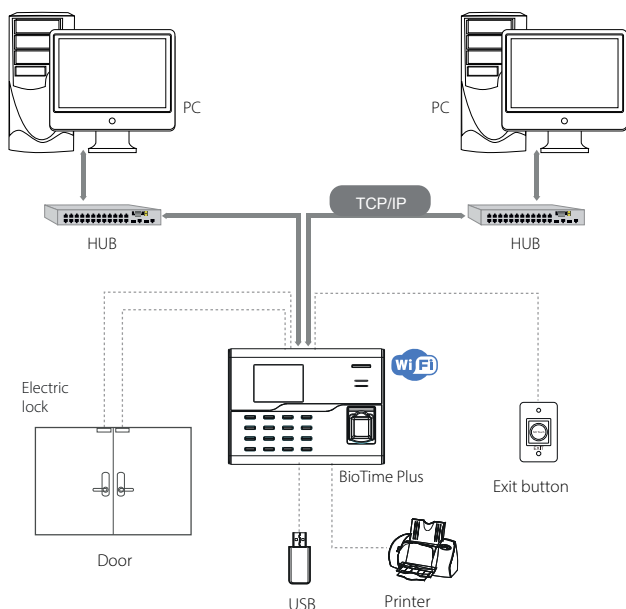

INTERFACE

